

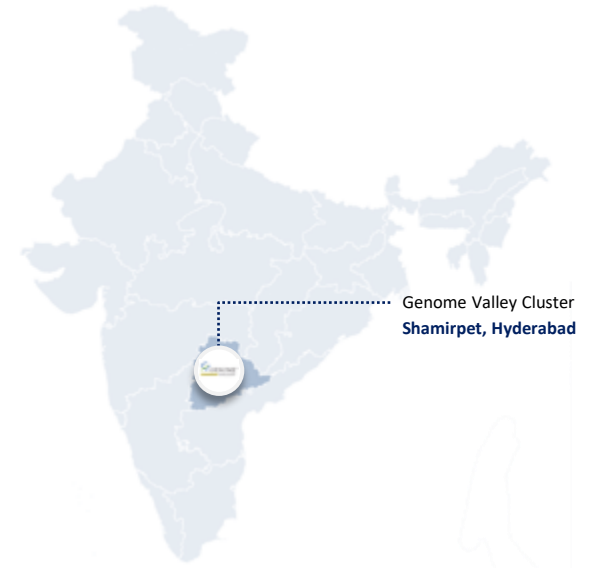

March 2022



Genome Valley Cluster, Hyderabad



TELANGANA STATE SNAPSHOT

1/3rd of global Vaccine output

35% of India's Pharmaceutical production

20+ Lifesciences and Medtech incubators in Hyderabad



40% of total API production and 50% of API export



Only state to have 200+ USFDA approved facilities

Overview

Genome Valley is India's first systematically developed lifesciences cluster, offering world-class single and multi-tenanted infrastructure

200+
COMPANIES

60+
START-UPS
INCUBATED

3.2
MN SQ FT WORLD-
CLASS LAB SPACE

3
INCUBATION
CENTERS

20,000+
WORKFORCE



GENOME™
HYDERABAD VALLEY

Why Genome Valley?



Ecosystem

- Spread over 25 sq. kms, Genome Valley is a **highly networked and sustainable ecosystem** that enables the companies to achieve success at both national and international level.
- The purpose-built cluster is home to **200+** major domestic and global including leading Contract Research Organizations (CROs), vaccine manufacturers and world renowned R&D organizations.
- Over the years, Genome Valley has emerged as a **CRO hub, vaccine hub** and a preferred destination for **R&D companies**.



Why Telangana?

- The **investor friendly policies**, public investment and availability of skilled talent has played a critical role in the growth of lifesciences companies in Telangana.
- Hyderabad as a lifesciences hub is projected to become a **\$50 billion** industry by 2030.
- The city has **readily available workforce**, with 45% of the total employed workforce in the Pharma, MedTech and Biotechnology GIC sector



Government Policies

- In January 2015, the state announced The Telangana State Industrial Project Approval and Self-Certification System (**TSiPASS**), a super-quick industrial clearance system which attracted increased investments in lifesciences sector.
- Genome Valley has been accorded with the status of **Industrial Area Local Authority (IALA)** by Govt. of Telangana in 2018
- The cluster has excellent support infrastructure for R&D activities, created by the Telangana State Industrial Infrastructure Corporation (**TSIIC**) through public-private partnerships with major partners

Infrastructure



Connectivity

The cluster benefits from excellent transport connections

- Rajiv Gandhi International Airport is **60 minutes** away and is easily accessible for domestic and international flights
- Genome Valley is well connected to the rest of the city through **Outer Ring Road** encircling Hyderabad



Support Infrastructure

Power

- Fully operational dedicated sub stations in Genome Valley for uninterrupted power supply.

Water Supply

- Direct supply by Hyderabad Metropolitan Water Supply and Sewerage Board (HMWSB)
- Storage Capacity of > 5,000 KL per day within Genome Valley

Industrial Waste Management

- Dedicated waste management for safe disposal of waste



Social Infrastructure

Residential Clusters

- Turkapally – 5 to 10 minutes distance
- Alwal and Kompally – 25 to 30 minutes distance

Hospitals

- RVM institute of Medical Sciences - 10 minutes
- Medicit Institute of Medical Sciences - 20 minutes



INNOPOLIS

Innopolis combines design and functionality to inspire top-notch science, complete with a modern atrium that serves as a collaborative space. With the tallest buildings in the cluster, it is poised to be an iconic destination for research and innovation. The facility offers wet/dry laboratory spaces, specialist office and pilot plant spaces for life sciences companies.

Master Plan



Typical Floor Plan – Building 2727

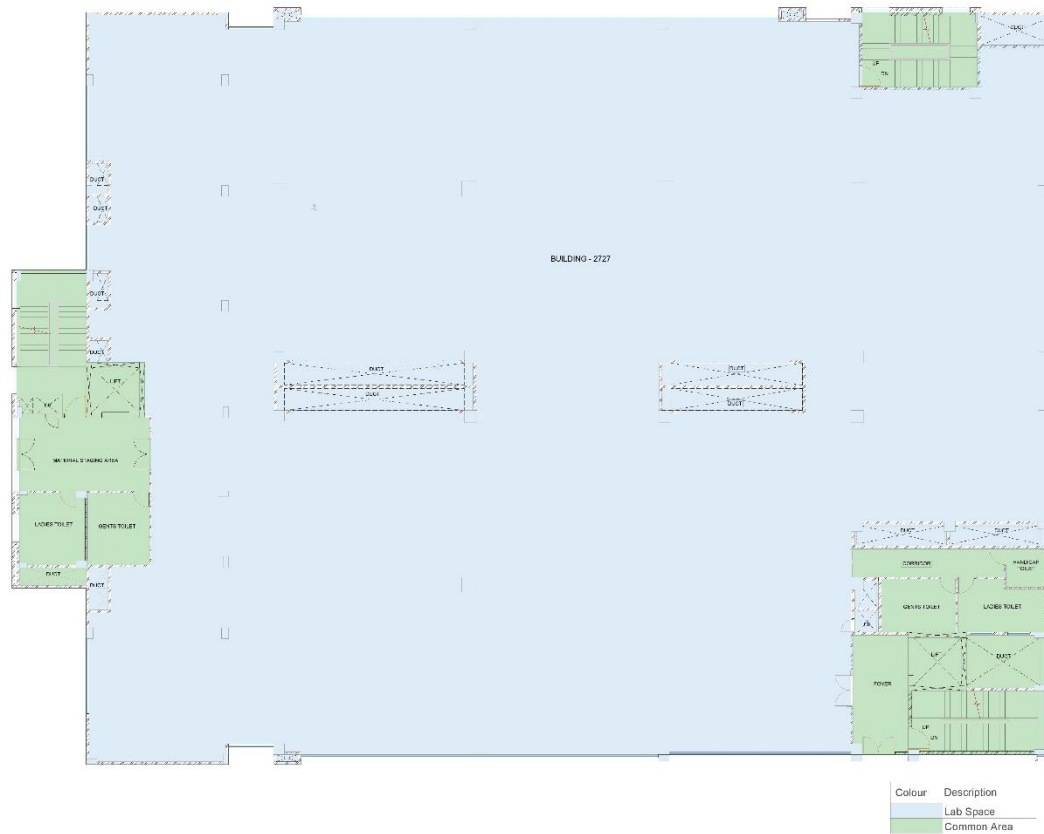

Typical Floor Plan – Building 4545

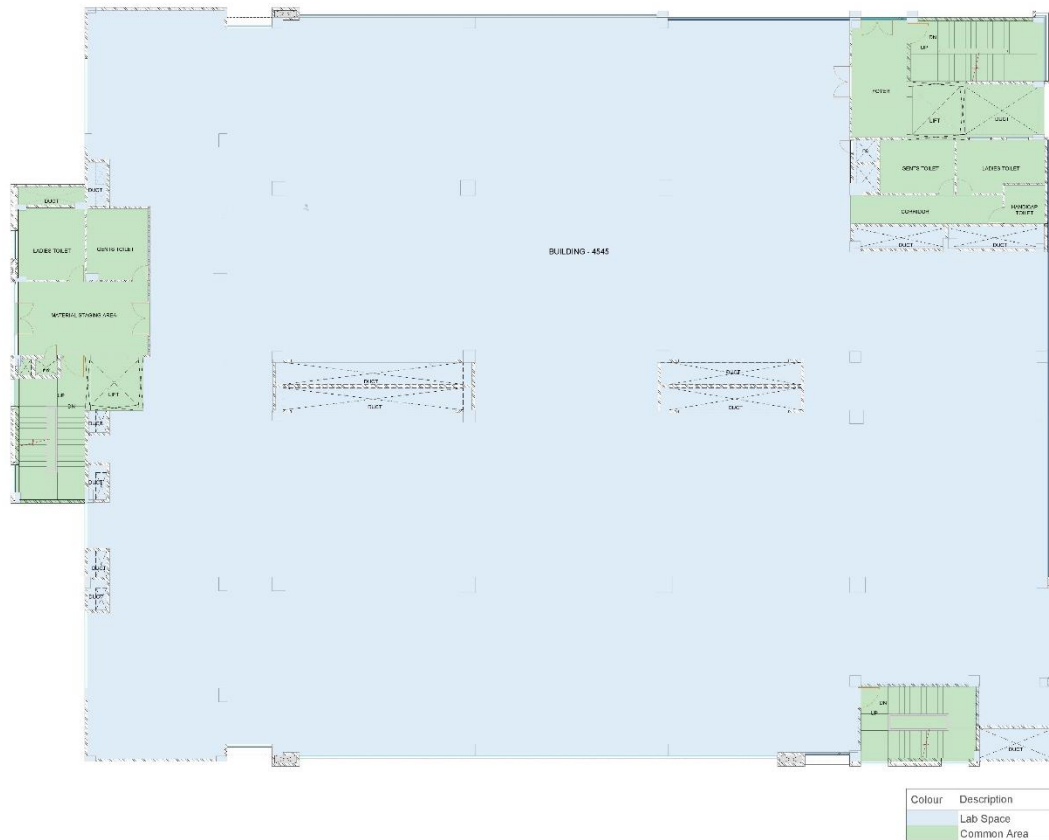

Typical Floor Plan – Building 3600A & C



Colour	Description
Light Blue	Lab Space
Light Green	Common Area



Typical Floor Plan – Building 4500



Colour	Description
Light Blue	Lab Space
Green	Common Area



Typical Floor Plan – Building 2700

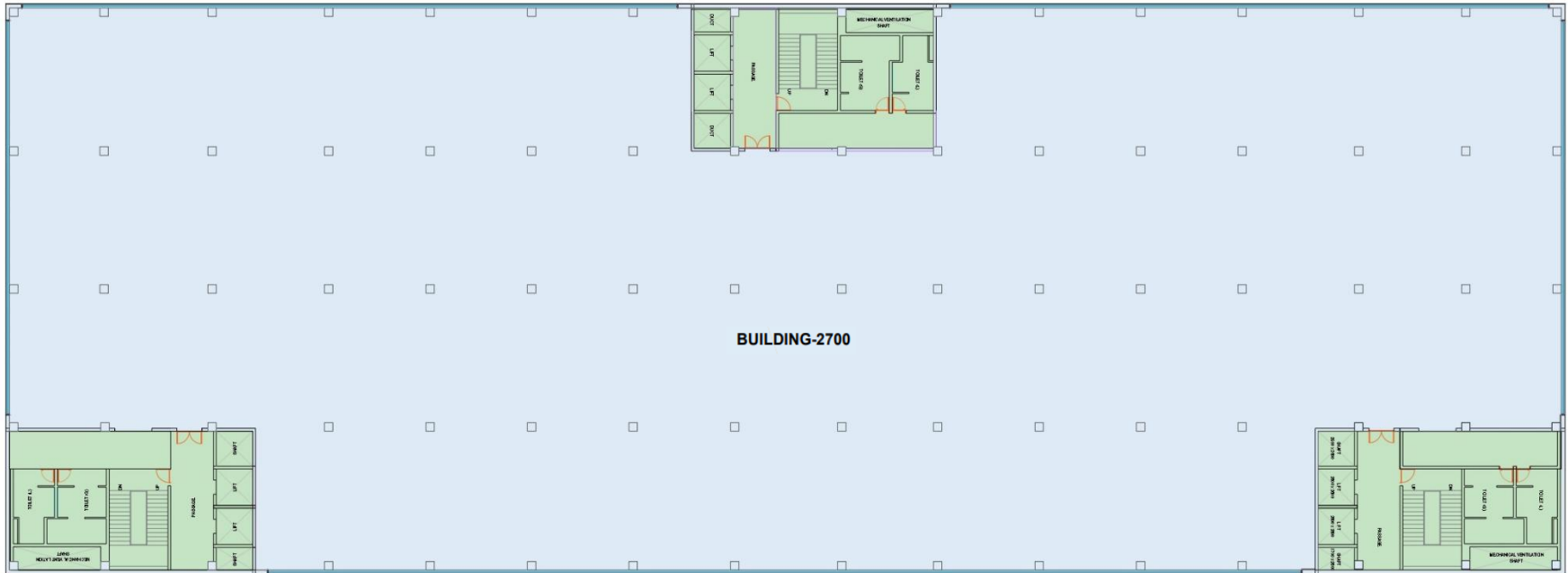

Colour	Description
	Lab Space
	Common Area



Area Statement

S No	Building	Super Built-up Area (sft)
1	Building 2727	1,04,150
2	Building 4545	1,04,150
3	Building 3600A & C	1,04,040
4	Building 4500	1,02,530
5	Building 2700	1,53,675
Total Leasable area		5,68,545

Total Plot Area
~ **9.2 Acres**

Total Development
~ **5,70,000 SF**

S No	Support Infra	Super Built-up Area (sft)
1	Chemical Stores (G+2)	7,080
2	Parking (Stilt floor)	1,32,570

About The Project

3-D Rendering



**Development Status: Building 2727 (~100,000 SF) leased to India's leading CRO. Fit-outs underway.
Building 4545 (~100,000 SF) will be ready for fit-outs by June'22**

Location Link [here](#)

About The Project

3-D Rendering



**Development Status: Building 2727 (~100,000 SF) leased to India's leading CRO. Fit-outs underway.
Building 4545 (~100,000 SF) will be ready for fit-outs by June'22**

Location Link [here](#)

About The Project

3-D Rendering



**Development Status: Building 2727 (~100,000 SF) leased to India's leading CRO. Fit-outs underway.
Building 4545 (~100,000 SF) will be ready for fit-outs by June'22**

Location Link [here](#)

About The Project

3-D Rendering



**Development Status: Building 2727 (~100,000 SF) leased to India's leading CRO. Fit-outs underway.
Building 4545 (~100,000 SF) will be ready for fit-outs by June'22**

Location Link [here](#)

About The Project

3-D Rendering



**Development Status: Building 2727 (~100,000 SF) leased to India's leading CRO. Fit-outs underway.
Building 4545 (~100,000 SF) will be ready for fit-outs by June'22**

Location Link [here](#)

About The Project

3-D Rendering



**Development Status: Building 2727 (~100,000 SF) leased to India's leading CRO. Fit-outs underway.
Building 4545 (~100,000 SF) will be ready for fit-outs by June'22**

Location Link [here](#)

About The Project

3-D Rendering



About The Project

3-D Rendering



About The Project

3-D Rendering



About The Project

3-D Rendering



Warm-shell

Solution for every need

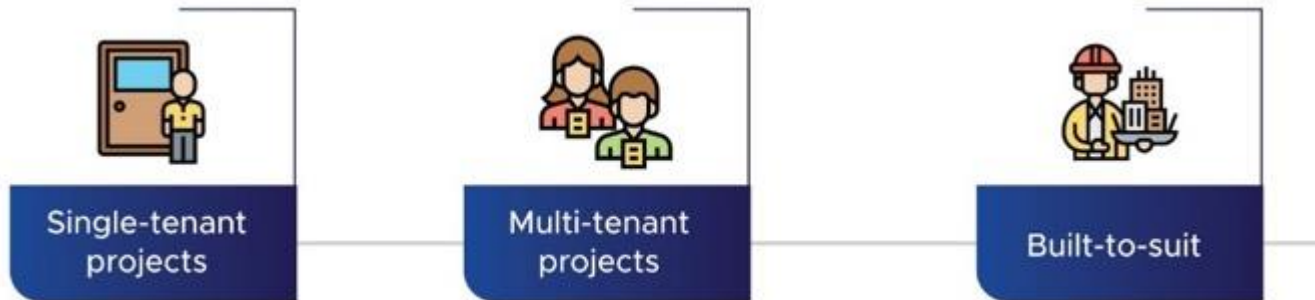

We provide an “extended” warm-shell with several inclusions

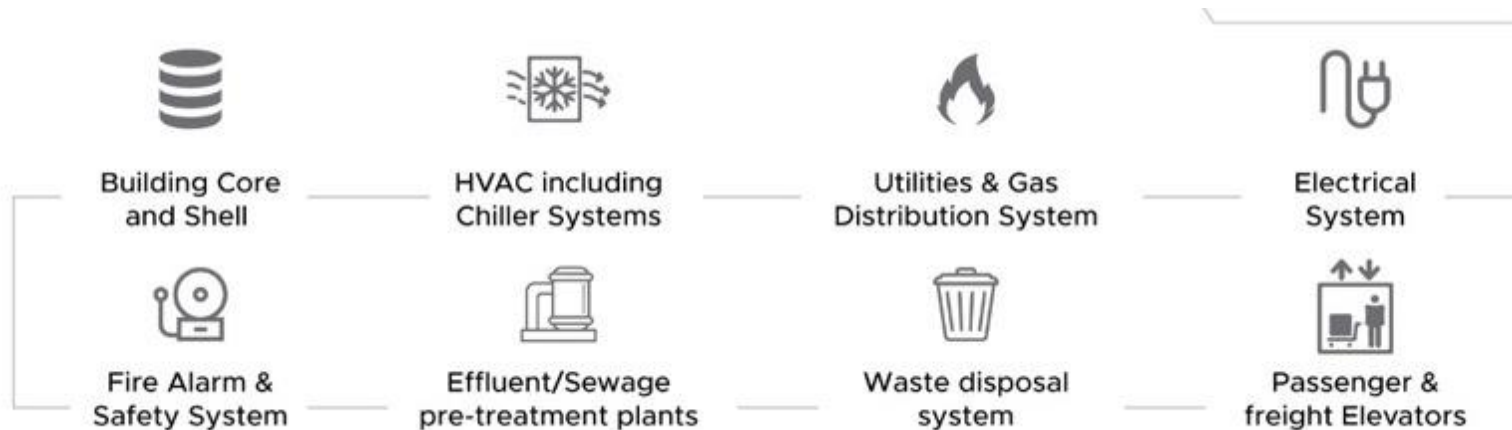

About Rx Propellant

Ecosystem Offerings

We offer a wide range of solutions encompassing infrastructure, talent nurturing, collaboration and incubation

Asset Management

Real estate solutions from development advisory, acquisition to funding & leasing.



Labspaces



Factories

Facilities Management

An exclusive Lifesciences facility services partnership to support growth acceleration through asset performance optimization

Edu-skilling Initiatives

Focused on providing industry-aligned skilling programs for Lifesciences workforce

Networking Platform

An Independent Cluster Development Enterprise dedicated to real asset growth acceleration

Incubator

A launchpad for startups that covers their needs for infrastructure, talent, advisory and funding



Pan-India Footprint

Rx Propellant is currently managing and developing **4 Mn SF** of infrastructure solutions for Lifesciences & Pharma sectors, with a pipeline of **5 Mn SF** pan-India

Asset Management Portfolio

Genome Valley, Hyderabad

Six projects with a development of 1.5 Mn SF in Genome Valley- India's leading Lifesciences hotspot

Bengaluru

Development of **2.5 Mn SF** of bespoke research & development spaces in proximity to Bengaluru's fast growing lifesciences ecosystem

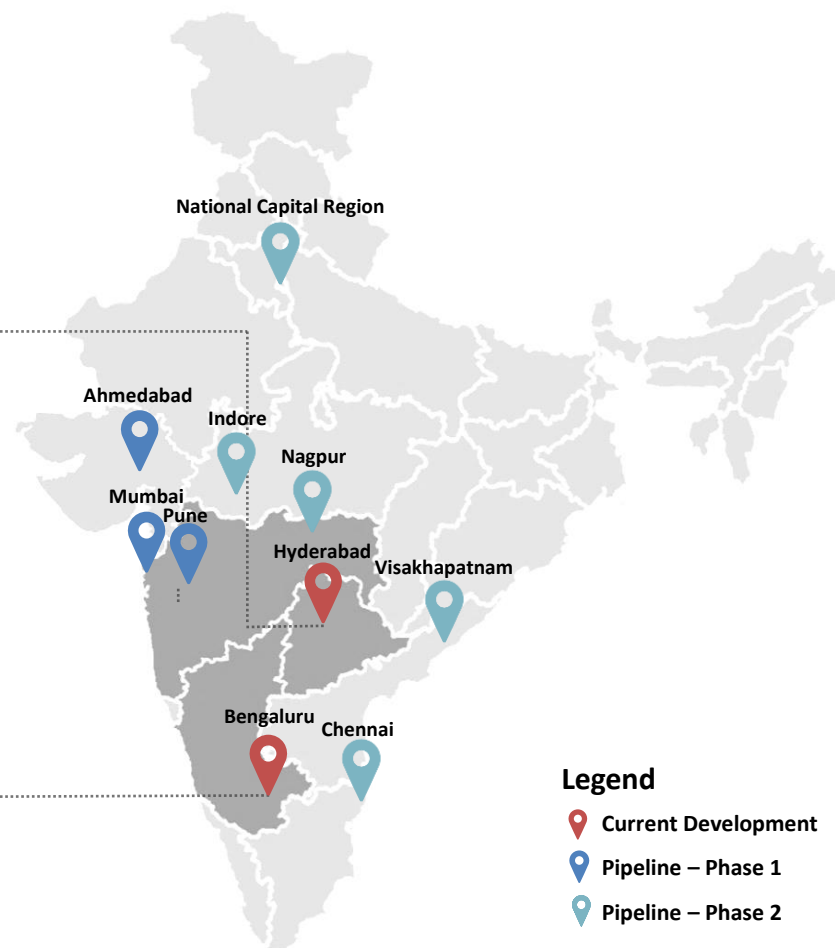

Legend

- 📍 Current Development
- 📍 Pipeline – Phase 1
- 📍 Pipeline – Phase 2

Scope of Operations

End-to-end asset solutions across spectrum of Lifesciences & pharma operations
 Enabling organizations to focus on core business functions



Product Offerings

Built-to-suit & multi-tenanted **Grade-A assets** to cater to the entire Lifesciences value chain

Target Sectors:



Key Offerings :

Labspace

Ground + 2,3 (typical) fitout-ready Warm shells to suit:



Flexi Factories

Ground, Ground + 1 (typical) fitout-ready Warm shells to suit:

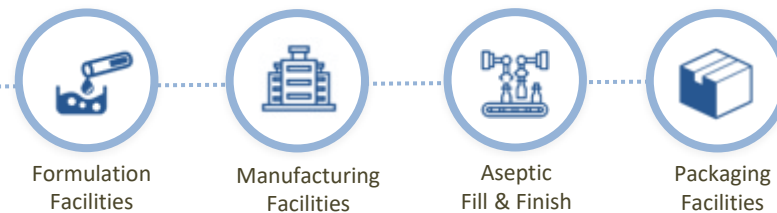

Labspaces : Product Classes

Illustrative Examples of product classes suited to Labspace Offerings:



R&D Laboratories



Vivarium



*Pilot Plants/
Production Labs*



Cleanrooms



*Specialized
Environments*



Factories : Product Classes

Illustrative Examples of product classes suited to Flexi Factory Offerings:



*Formulation
Facilities*



*Manufacturing
Facilities*



*Aseptic
Fill & Finish*



*Packaging
Facilities*



About Developer & Partners



Primary business: Development and operations of public storage and RV parks.

Other businesses: Real Estate.

Track Record: 6 decades.

Headquarter: Los Angeles.

Area of operations: California, Texas, Utah, Arizona.

www.greensglobal.com



Primary business: Development and operations of hotels, apartments and office spaces.

Other businesses: Gas stations, real estate.

Track Record: 3 decades.

Headquarter: Los Angeles.

Area of operations: California, Utah, Arizona, New Mexico.

www.greens.com



Primary business: Development of housing and life sciences parks.

Track Record: 5 decades.

Headquarter: Hyderabad.

Area of operations: Hyderabad + peripheral areas, Telangana.

www.modiproperties.com

Disclaimer

The information contained in this proposal (“Information”) is provided for informational and discussion purposes only and contains statements of opinion. The Information may not be relied on as legal, tax, or investment advice. The Information does not constitute an offer or a recommendation for any investment advisory or other services by JVRx and its affiliates and/ or any investment products it advises (collectively, “JVRx”, ‘we’, ‘us’). Each recipient should make its own evaluations of the Information herein and should consult their respective adviser as to legal, investment, tax, and related matters thereto. The Information is not intended to be and shall not be viewed as investment/ financial advice.

Any views expressed herein, unless otherwise indicated, are those of JVRx and are based on information available to it. These views are subject to change, without notice, based on market and other conditions. JVRx makes no representation as to the accuracy of such views. Such views may have become unreliable for various reasons, including changes in market conditions or economic circumstances.

Certain information contained herein may be based on information provided by independent third-party sources. JVRx believes that the sources from which such information has been obtained are reliable; however, it cannot guarantee the accuracy or completeness of such information or the assumptions on which the Information is based. Cerestra has no obligation to update the Information.

Certain current and prior investments may be highlighted in order to provide additional information regarding JVRx’s strategy, the types of investments it pursues, and current or anticipated exit strategies.

The Information herein is proprietary and confidential and may include commercially sensitive information. As such, the recipient of this proposal shall be obligated to keep the Information strictly confidential. The recipient acknowledges that any unauthorized use or circulation of this proposal and the contents hereof may result in irreparable loss/ damage to JVRx. Therefore, the Information herein shall not be copied or used for an unauthorized purpose, reproduced, republished, or posted in whole or in part, in any form, without the prior written consent of JVRx. The recipient of the proposal shall not make any communication regarding the information contained herein, including disclosing that the Information have been provided to such recipient, to any person other than its authorized representatives assisting in considering the information contained herein. Each recipient agrees to the foregoing and to return (or delete or destroy) upon JVRx’s instructions the proposal/ Information promptly upon request.



Contact details for leasing :



Milind Ravi | CEO
Suite 301, Ashoka Vishnu Capitol,
Road Number 2, Banjara Hills,
Hyderabad - 500034,
Telangana
+91 91005 92850
milind@rxpropellant.in
www.rxpropellant.in



Waseem Akhtar | AVP
5-4-187/3&4, Soham Mansion,
MG Road, Secunderabad,
Hyderabad - 500003,
Telangana
+91 93475 76914
waseem@modiproperties.com
www.modiproperties.com